

MAXI MILLER

Plastic Pipes

DESCALING

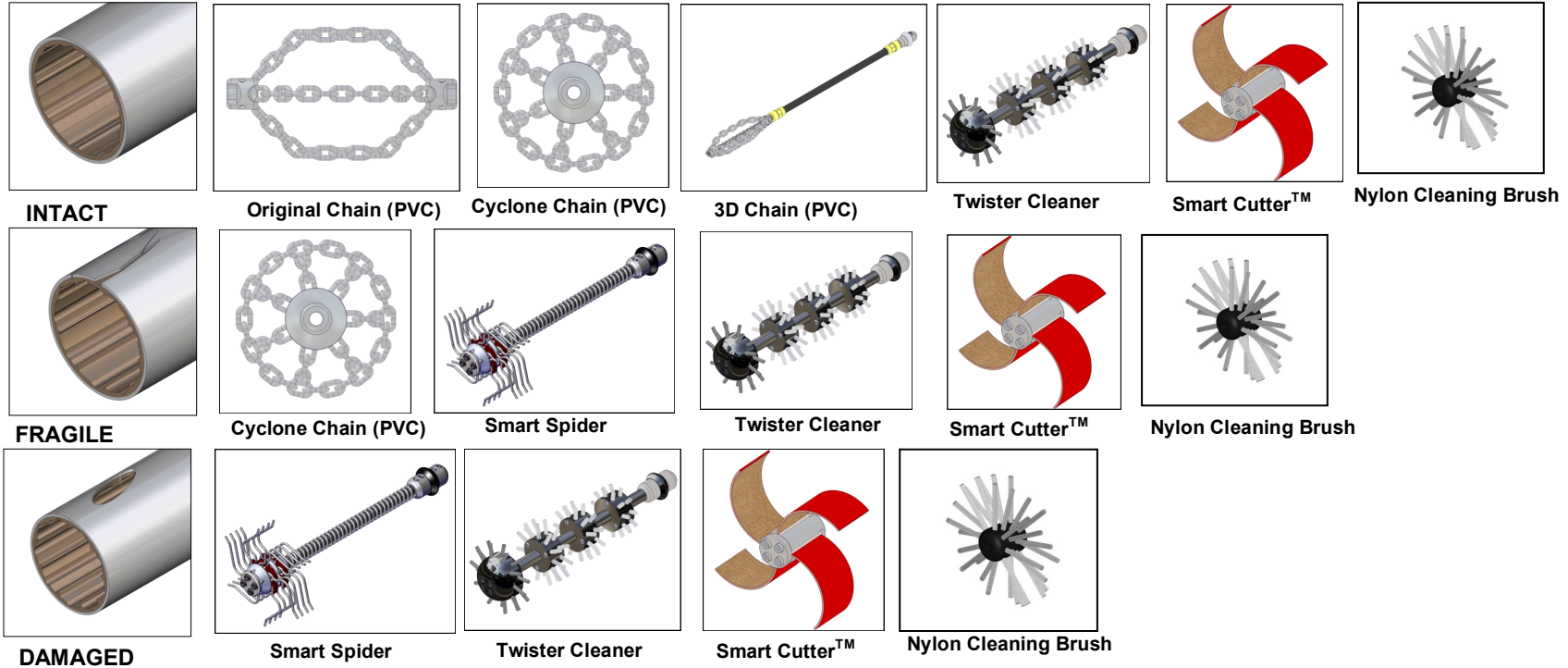

SPECIAL

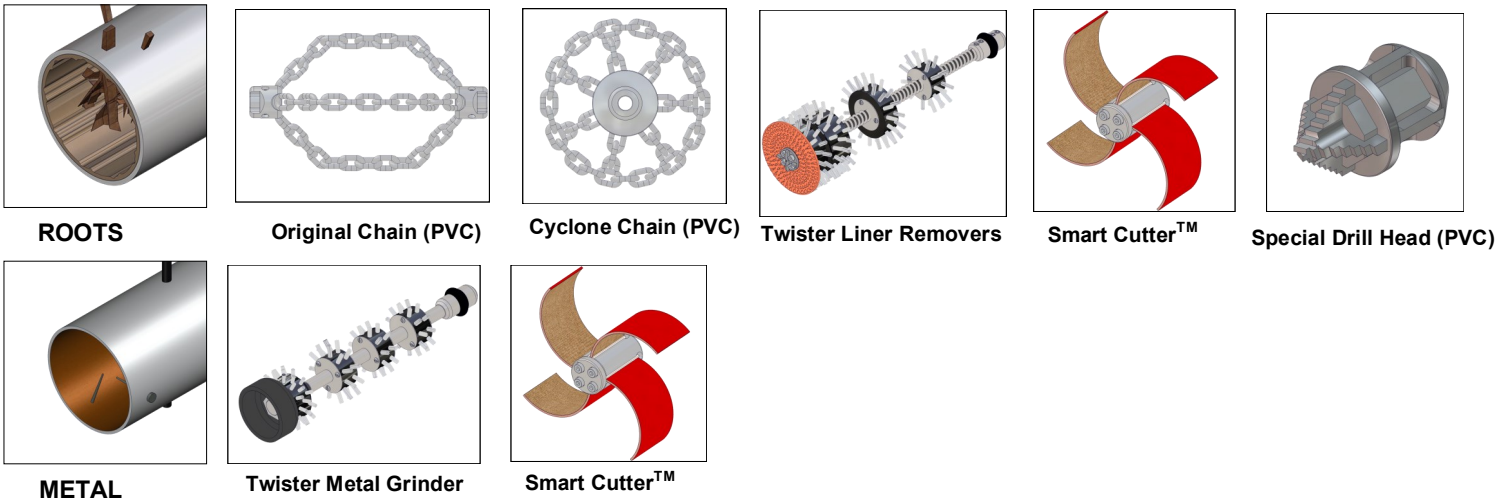

COLLAPSED LINER

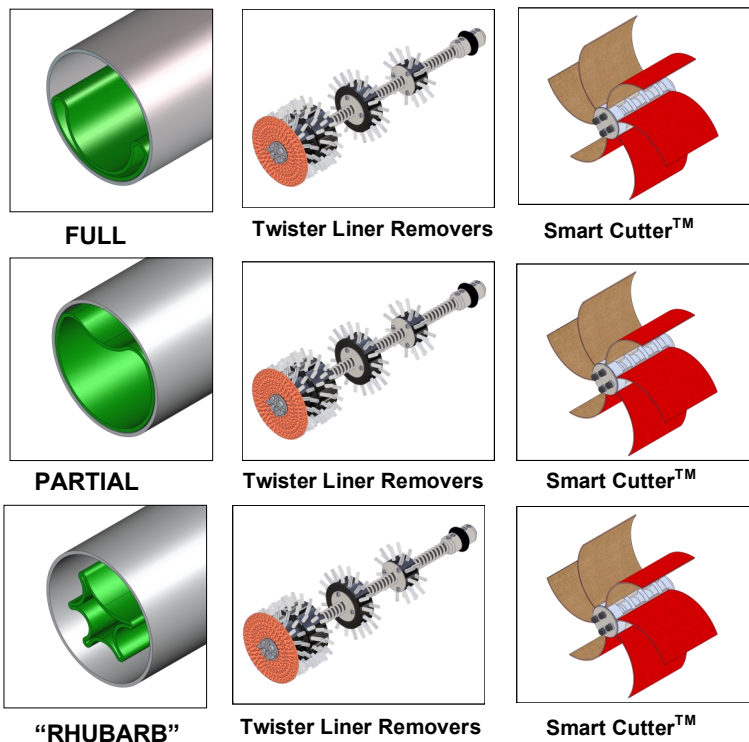

CONCRETE

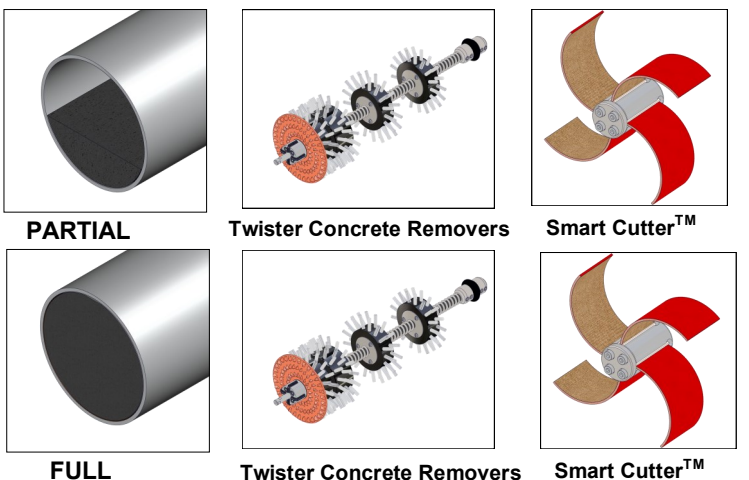

Maxi Miller

Shaft Diameter: 12mm (1/2")

Range: 30 metres (100 ft)

Additional Extension:* 10 metres (32 ft)

Recommended Range: DN70-250 (3-10")

Outer Casing: Thick

| Available Tools | Size Range |
|--|-------------------|
| Original Chain (PVC) | DN70-250 (3-10") |
| 3D Chain (PVC) | DN70-100 (3-4") |
| Cyclone Chain (PVC) | DN70-250 (3-10") |
| Smart Spider | DN100-150 (4-6") |
| Twister Metal Grinder | DN100 (4") |
| Twister Liner Remover | DN100-150 (4-6") |
| Twister Concrete Remover | DN100-150 (4-6") |
| Tiger Twister Liner & Concrete Remover | DN100-150 (4-6") |
| Smart Cutter™ | DN70-225 (3-9") |
| Special Drill Head (PVC) | DN70-100 (3-4") |
| Nylon Cleaning Brush** | DN100-300 (4-12") |

* Shaft extension sold separately.

** Nylon cleaning brushes should only be used for removing fine dust or soft blockages