

OPERATION & SAFETY MANUAL



! WARNING

*These instructions are for your personal safety. Always ensure that you have read and understood these instructions before using the equipment. **SAVE THESE INSTRUCTIONS FOR FUTURE REFERENCE.***

TABLE OF CONTENTS

SAVE ALL WARNINGS AND INSTRUCTIONS FOR FUTURE REFERENCE

TOPIC	PAGE
General Safety Information	3
Storage & Disposal	4
General Information & Intended use	5
Operating Instructions	6
Changing The Tool Heads	7
Attaching The Lasso Grabber Head	9
Maintenance	10
Repairing Damaged or Worn Out Cable	11
Accessories, Spares & Recommended Parts	12
Warranty Policy & Procedure	13

To watch practical demonstration videos, take a course, or to download an electronic copy of these Instructions, please visit www.picoteinstitute.com. Please note that videos and courses are not intended as a replacement or alternative to this operating and safety manual, but only as an additional learning tool.

SAFETY INFORMATION

SAVE ALL WARNINGS AND INSTRUCTIONS FOR FUTURE REFERENCE

WARNING

This section contains important safety information.
Failure to comply could result in serious injury or death.

Safety Symbols

Safety symbols are used throughout this manual to draw attention to potential hazards.



Danger risk of serious injury, follow instructions.



Danger risk of serious injury from moving parts, follow instructions.

Personal Protective Equipment (PPE)



Suitable eye protection to protect against injuries and chemicals from irritating eyes.



Suitable ear protection to protect against hearing loss.



Suitable heat and cut-resistant gloves to help prevent any hand injuries. Any open injuries or skin irritations should always be covered to avoid contact with sewage, chemicals or dust.



Suitable respirator to prevent any dust or fumes being inhaled or consumed, which could cause occupational asthma or dermatitis.

STORAGE & DISPOSAL

SAVE ALL WARNINGS AND INSTRUCTIONS FOR FUTURE REFERENCE



WARNING

This section contains important safety information.
Failure to comply could result in serious injury or death.

STORAGE

It is recommended that the Small Grabber is stored indoors to protect it from rain and sunlight and also in a constant ambient temperature. It is recommended that the 5m (16ft) long Small Grabber is stored in a coil with 2 turns and the 10m (32ft) long Small Grabber stored in a coil with 4 turns.

DISPOSAL

The Tool Heads, Shaft and Handle can be recycled in metal waste collection points.
The plastic outer casing of the shaft should be disposed of as plastic waste.

Always follow your local waste handling rules and regulations.

GENERAL INFORMATION AND INTENDED USE

SAVE ALL WARNINGS AND INSTRUCTIONS FOR FUTURE REFERENCE

Small Grabber

- Available in two lengths: 5m (16ft) and 10m (32ft), with no extension options.
- Comes with four models of Small Grabber heads for various applications: Jaw, Lasso, Magnet, and Hook.
- There are three package options available, each including all four grabber heads:

Small Grabber Product List	
PN	Description
2370000041	Small Grabber 5m (16ft) Package
2370000042	Small Grabber 10m (32ft) Package
2370000040	Small Grabber 5&10m (16 & 32ft) Package (with shared Grabber Heads)

Intended Use

- Recovering lost items or foreign objects located within a pipe.
- Always use a CCTV camera in conjunction with using the Small Grabber whenever possible.

General Description

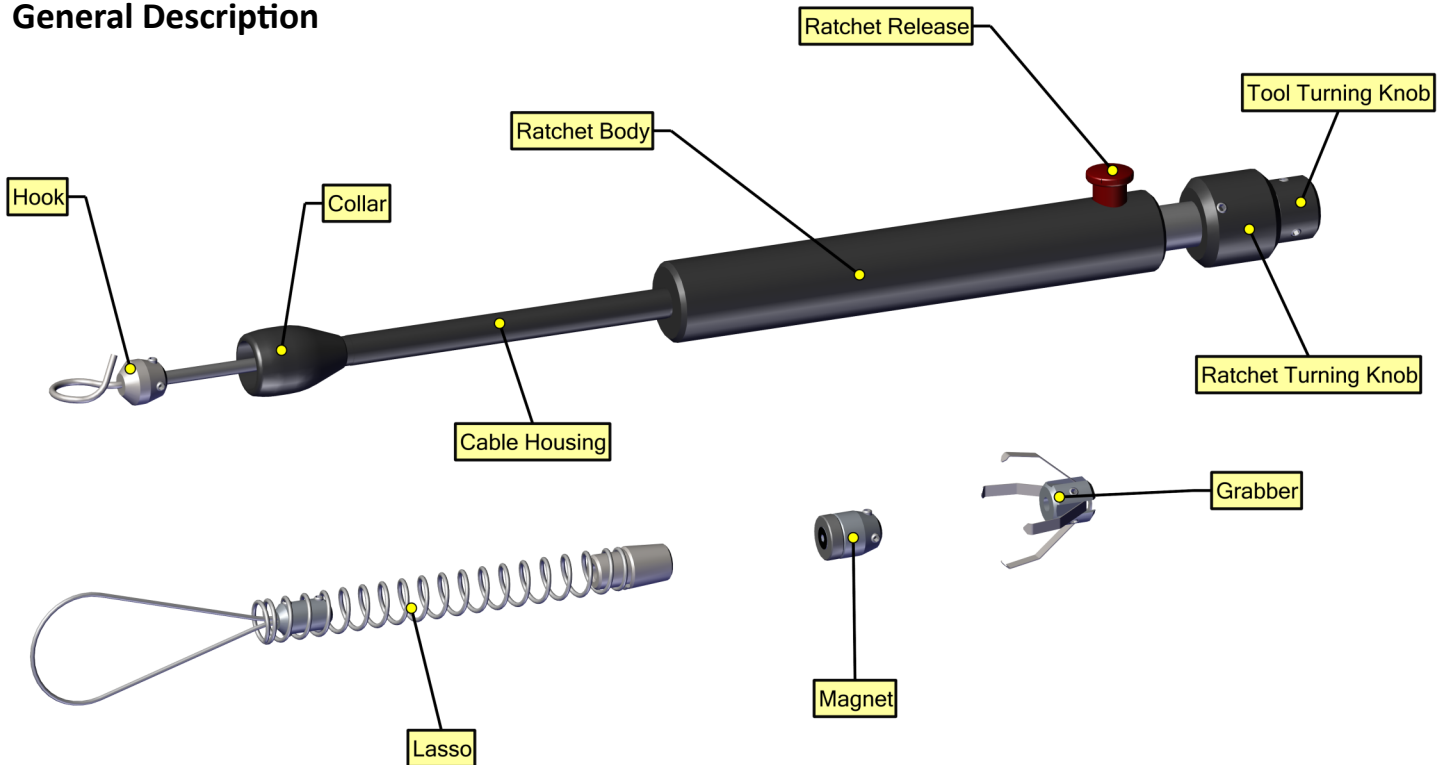

OPERATING INSTRUCTIONS

SAVE ALL WARNINGS AND INSTRUCTIONS FOR FUTURE REFERENCE

NOTE: The Small Grabber is recommended to be used in an **uncoiled** position so less force is required to operate the tool.

Operation

- To close the tool, rotate the tightening knob clockwise.
- To open the tool, lift the red knob and push the tightening knob forward.
- To turn the tools clockwise, rotate the rotating knob clockwise. If turned counterclockwise, the tool will turn counterclockwise.

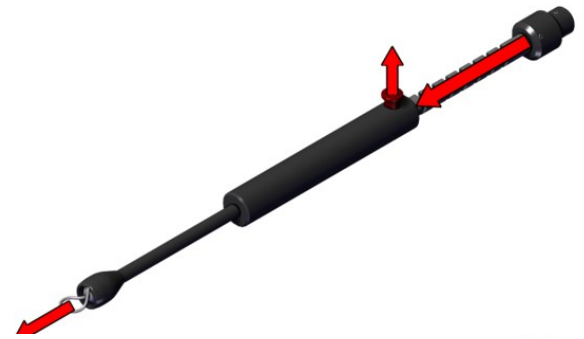

Attaching the Jaw, Magnet, or Hook Grabber Heads

- Insert the collar onto the wire, then turn it clockwise. Be cautious to prevent cross-threading.
- To remove the collar, turn it counterclockwise and pull it through the wire.

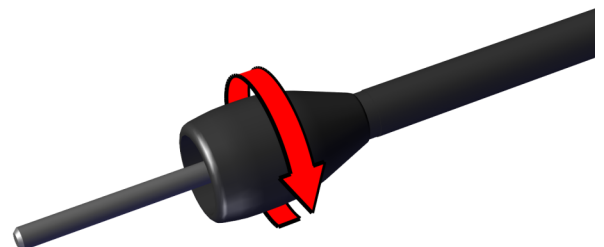
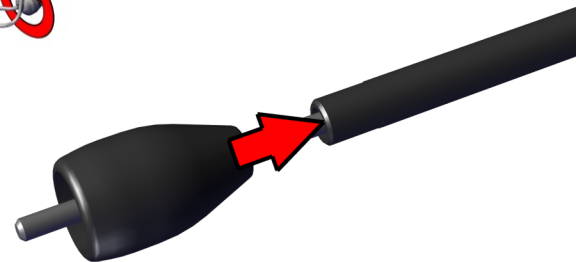

OPERATING INSTRUCTIONS

SAVE ALL WARNINGS AND INSTRUCTIONS FOR FUTURE REFERENCE

- Insert the chosen tool to the end of the wire.

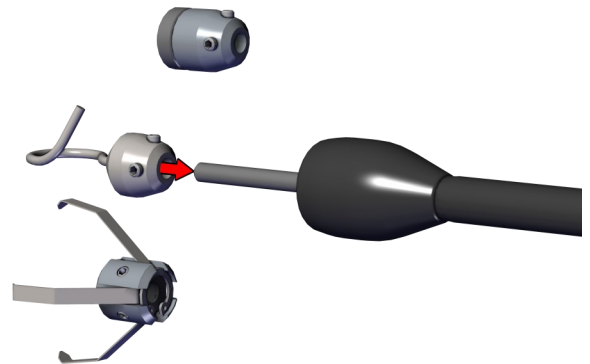

- Use a 2.5mm hex key to symmetrically tighten the set screws from both directions.

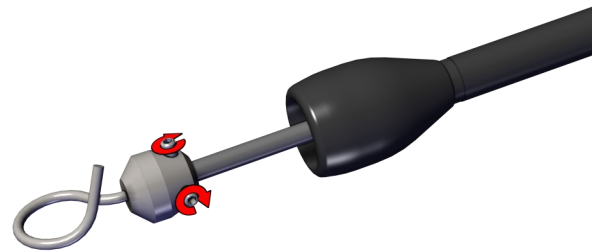

- To remove any of the tools, loosen the setscrews by turning them counterclockwise.

Attaching the Lasso Head

- Insert the spring onto the wire, then rotate it clockwise.
- Be cautious to prevent cross-threading.

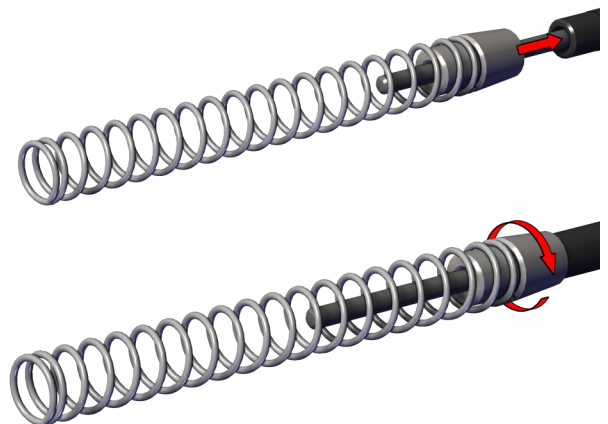

OPERATING INSTRUCTIONS

SAVE ALL WARNINGS AND INSTRUCTIONS FOR FUTURE REFERENCE

- Thread the loop onto the wire, ensuring that the wire's end is fully inserted into the connector and tighten the screws.

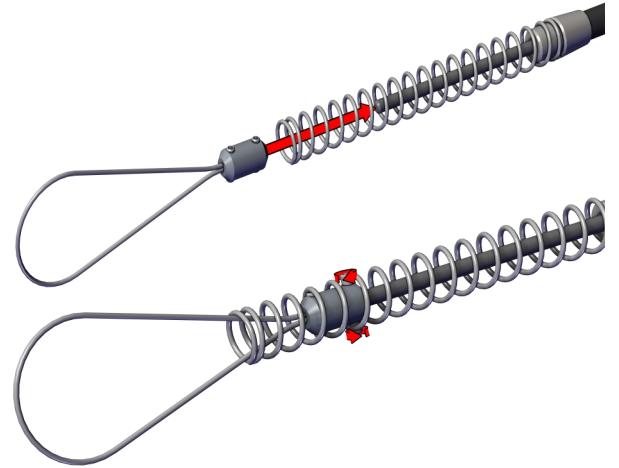

- To remove the tool, loosen the set screws and follow the previous steps in reverse order.

MAINTENANCE

SAVE ALL WARNINGS AND INSTRUCTIONS FOR FUTURE REFERENCE

- After each use, make sure to remove any dirt from the screw handle and apply multi-purpose grease to lubricate the grooved shaft.

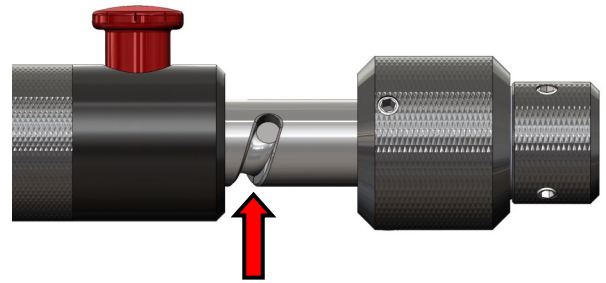

- Thoroughly clean any dirt or debris from each of the tool mechanisms used during the operation to ensure optimal performance and longevity.

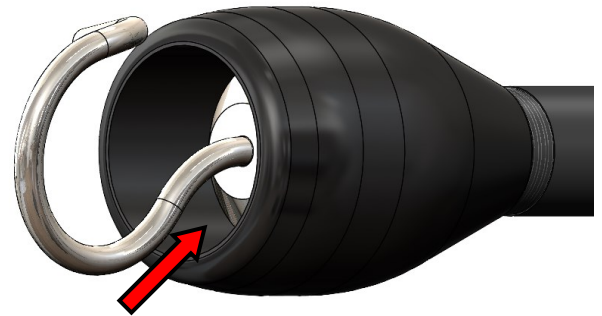

REPAIRING A DAMAGED OR WORN OUT CABLE

SAVE ALL WARNINGS AND INSTRUCTIONS FOR FUTURE REFERENCE

NOTE! The Small Grabber should only be repaired in an uncoiled position.

1. Remove all accessories from the tool end of the grabber
2. Shorten the damaged part or at least cut off 25mm (1") of the wire using wire cutters.
3. Round off any sharp edges on the end.
4. Carefully cut the outer casing, making sure to avoid cutting the wire inside.
5. Cut the same amount of outer casing off as you have shortened the wire.
6. Create new threads on the outer casing using a G 1/4" thread die.
7. Ensure the threads are at least 25 mm (1") in length.

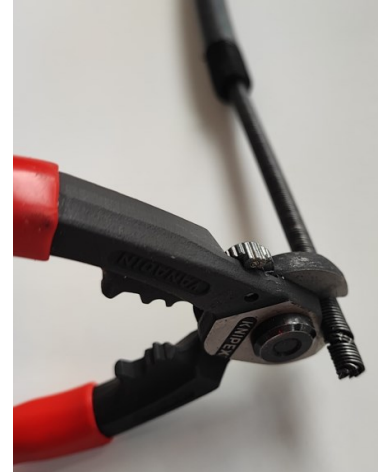

PARTS AND ACCESSORIES

SAVE ALL WARNINGS AND INSTRUCTIONS FOR FUTURE REFERENCE

WARNING

This section contains important safety information.
Failure to comply could result in serious injury or death.

You must use only Picote Solutions accessories and attachments with the Product as described in this Operation and Safety Manual. The use of other accessories or attachments could present a risk of injury.

The accessories or attachments should only be used in the proper and intended manner.

Small Grabber Product & Parts	
PN	Description
2370000041	Small Grabber 5m (16ft) Package
2370000042	Small Grabber 10m (32ft) Package
2370000040	Small Grabber 5&10m (16 & 32ft) Package (with shared Grabber Heads)
Spare Parts	
2370000043	Jaw Grabber Head
2370000044	Lasso Grabber Head
2370000045	Magnet Grabber Head
2370000046	Hook Grabber Head



Jaw Grabber: Claw-like motion and overlapping jaw design ensures accuracy, especially for smaller objects.

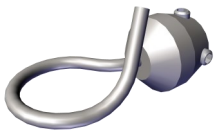

Hook Grabber: Rotational scooping motion captures items & provides secure handling by locking into position before retrieving.



Magnet Grabber: Strong magnet retrieves metal items that are otherwise hard to grab.



Lasso Grabber: Offering good maneuverability and a unique spring design, it ensures a constant grabbing force to lasso items, making it ideal for a variety of objects.

WARRANTY POLICY AND PROCEDURE

SAVE ALL WARNINGS AND INSTRUCTIONS FOR FUTURE REFERENCE

Limited Warranty:

Picote warrants to the original End User that the Product purchased by such End User will operate in accordance with, and substantially conform to their published specifications when shipped or otherwise delivered to the End User and for a period of one (1) year, except electric motors for which the warranty period shall be six (6) months, provided, however, that Picote does not warrant any claim or damage under this Warranty if such claim or damage results from:

1. Consumable parts or normal wear and tear resulting from use of the Products,
2. Product overload or overheated motor,
3. Regular periodic maintenance of Products,
4. Misuse, neglect, or improper installation or maintenance of the Products, or use of Products not for their intended purpose,
5. Products that have been altered, modified, repaired, opened or tampered with by anyone other than Picote or an authorized Picote Service Centre, or unsuitable or unauthorized spare parts, accessories or third party products when using the Products or;
6. the use of the Products not in compliance with their respective Documentation, user manuals, safety and maintenance instructions, and any usage restrictions contained therein, or
7. accident, fire, power failure, power surge, or other hazard.

Otherwise, the Products are sold AS IS. End User is responsible for using the Products within their specifications and instructions as contained in the Documentation.

EXCEPT AS SPECIFIED IN THIS WARRANTY, ALL EXPRESS OR IMPLIED CONDITIONS, REPRESENTATIONS, AND WARRANTIES INCLUDING, WITHOUT LIMITATION, ANY IMPLIED WARRANTY OR CONDITION OF MERCHANTABILITY, FITNESS FOR A PARTICULAR PURPOSE, NON INFRINGEMENT, SATISFACTORY QUALITY OR ARISING FROM A COURSE OF DEALING, LAW, USAGE, OR TRADE PRACTICE, ARE HEREBY EXCLUDED TO THE EXTENT ALLOWED BY APPLICABLE LAW. TO THE EXTENT AN IMPLIED WARRANTY CANNOT BE EXCLUDED, SUCH WARRANTY IS LIMITED IN DURATION TO THE WARRANTY PERIOD. BECAUSE SOME STATES OR JURISDICTIONS DO NOT ALLOW LIMITATIONS ON HOW LONG AN IMPLIED WARRANTY LASTS, THE ABOVE LIMITATION MAY NOT APPLY. This disclaimer and exclusion shall apply even if the express warranty set forth above fails of its essential purpose.



Please Contact:
Your Reseller / Salesperson or Picote

www.picotegroup.com



International Offices

Finland. United Kingdom. USA.

Technical Support

support@picotesolutions.com

Production & R&D

Pienteollisuustie 24
06450 Porvoo, Finland
support@picotesolutions.com

E-Learning

Free Connection Collar 2.0 - Equipment
101 E-learning course is available at:
www.picoteinstitute.com

Claims

claims@picotesolutions.com

Authorised Resellers:

www.picotesgroup.com/resellers